



# *Corporate Events, Meetings, & Seminars* **2026**





**THE LODGE**  
SNOW VALLEY

# *Lodge Rental*

**If you can dream it, we can make it happen!**

This brochure is intended for general corporate events, meetings, & seminars, and is not an exhaustive list of all event options.

In past summers, we have successfully hosted the Edmonton Symphony Orchestra's "Symphony Under The Sky" outdoor summer performances, were a major venue for the Edmonton International Jazzfest, have hosted a week-long employee wellness retreat for a major healthcare provider, and have successfully been the venue of many other "outside the box" events.

Have a grand event vision? Please get in touch; we can help turn it into a reality!





# Events, Meetings & Seminars

## Monday to Friday

### Full Day (over 5 hours)

**\$1,400** without meal service

**\$850** with one meal

**\$600** with two meals

### Half Day (up to 5 hours)

**\$850** without meal service

**\$600** with one meal

### Corporate Events Capacity - 200

Full round-tables with 10 people per table

### Meeting & Seminar Capacity - 90

2/3 full round-tables with 6 people per table

Maximum capacity 200.

No outside caterers.

#### Includes

- 60" round tables
- chairs
- linens
- risers with white curtain backdrop
- 3 easel stands
- set up & teardown of event space
- water jugs & glasses
- registration table
- podium with microphone
- complimentary wifi
- separate buffet room

#### Rental add-ons

- screen & projector - \$150

5% GST will be added to all prices.

Food, beverage & corkage prices are subject to a 20% service charge.

All prices are subject to change without notice.



**THE LODGE**  
SNOW VALLEY

*Food  
&  
Beverage*





**THE LODGE**

SNOW VALLEY

# Coffee Station

## Beverages

Tea & Coffee Station \$52/coffee carafe

Bottled Pop and/or Water \$3.5/ea

Bottled Juice \$4/ea

## Pastries

Assorted Muffins \$24/dozen

Cinnamon Buns \$24/dozen

Assorted Cookies \$22/dozen

Assorted Dessert Squares \$24/dozen

## Snacks

Fresh Fruit Platter \$7/person

Cheese Platter \$8/person

Cured Meat Platter \$8.5/person

Fresh Vegetable Platter \$6/person

16" Pizzas (Cheese, Ham & Pineapple, Pepperoni, Vegetarian)  
\$27/each



5% GST will be added to all prices.  
Food, beverage & corkage prices  
are subject to a 20% service  
charge.  
All prices are subject to change  
without notice.

# Breakfast Selections

## Continental Breakfast \$19 per person

Muffins & Breakfast Pastries  
assorted selection

Orange Juice

Freshly Brewed Coffee & Tea

Fresh Fruit Platter seasonal  
selection

## Smart Start Breakfast \$20 per person

Vanilla Yogurt with granola

Orange Juice

Muffins & Breakfast Pastries  
assorted selection

Freshly Brewed Coffee & Tea

Fresh Fruit Platter seasonal  
selection

## Hot Breakfast Buffet \$33 per person

Bacon, Breakfast Sausage,  
& Ham Steaks

Muffins & Breakfast Pastries  
assorted selection

Scrambled Eggs

Fresh Fruit Platter seasonal  
selection

Pancakes

Orange Juice

Roasted Hashbrowns sweet  
onion & pepper

Freshly Brewed Coffee & Tea

Bagels assorted spreads

5% GST will be added to all prices.  
Food, beverage & corkage prices  
are subject to a 20% service  
charge.  
All prices are subject to change  
without notice.





**THE LODGE**

SNOW VALLEY

# *Lunch Favourites*

## **Chef's Soup & Build-Your-Own Sandwich Bar**

\$32 per person

**Hearty Vegetable Soup**

**Bread & Buns**

**Assorted Sandwich Toppings** selection of deli meats, cheese slices, fresh vegetables, and condiments

**Artisan Green Salad**

**Caesar Salad**

**Crudités** ranch dip & hummus

**Fruit Platter** seasonal selection

**Assorted Dessert Squares**  
includes gluten-friendly options

**Freshly Brewed Coffee & Tea**

## **BBQ Lunch Buffet** see entrées below for pricing

**Caesar Salad**

**Cold Pasta Salad**

**Coleslaw**

**Crudités** ranch dip & hummus

**Buns & Assorted Toppings**  
condiments, cheese slices, tomatoes, lettuce, onion, pickles

**Assorted Dessert Squares**  
includes gluten-friendly options

**Fresh Fruit Platter** seasonal selection

**Freshly Brewed Coffee & Tea**

## **entrée choices** per person. quantities of each must be specified

6 oz. rib eye steak \$42

6 oz. sirloin steak \$40

grilled chicken breast \$37

beef hamburger \$33

veggie burger \$34

beef hotdog \$30

5% GST will be added to all prices.  
Food, beverage & corkage prices  
are subject to a 20% service  
charge.  
All prices are subject to change  
without notice.



## THE LODGE

SNOW VALLEY

# Lunch Buffets

### Italian Lunch Buffet \$39 per person

**Garlic Bread**

**Caesar Salad**

**Artisan Green Salad** assorted dressings

**Italian Meats, Cheeses & Olives**

**Crudités** ranch dip & hummus

**Spaghetti & Meatballs**  
tomato & rosemary sauce

**Baked Four-Cheese Tortellini**

**Fresh Fruit Platter** seasonal selection

**Tiramisu** gluten friendly

**Freshly Brewed Coffee & Tea**

### Mediterranean Lunch Buffet \$39 per person

**Cream of Tomato Soup**

**Greek Salad** olives & crumbled feta

**Hummus** grilled flatbreads

**Souvlaki Skewers** chicken and beef

**Lemon Roasted Potatoes**

**Moroccan Rice**

**Spanakopita**

**Baklava**

**Freshly Brewed Coffee & Tea**

### Valley Lunch Buffet \$42 per person

**Assorted Dinner Rolls**  
includes gluten-friendly options

**Crudités** ranch dip & hummus

**Caesar Salad**

**Roast Chicken Breast** wild mushroom sauce

**Warm Garden Vegetables** seasonal selections

**Herb Roasted Potatoes** onions

**Baked Four-Cheese Tortellini**

**Assorted Dessert Squares**  
includes gluten-friendly options

**Fresh Fruit Platter** seasonal selection

**Freshly Brewed Coffee & Tea**

5% GST will be added to all prices.  
Food, beverage & corkage prices  
are subject to a 20% service  
charge.  
All prices are subject to change  
without notice.



# THE LODGE

SNOW VALLEY

## Lodge Floorplan

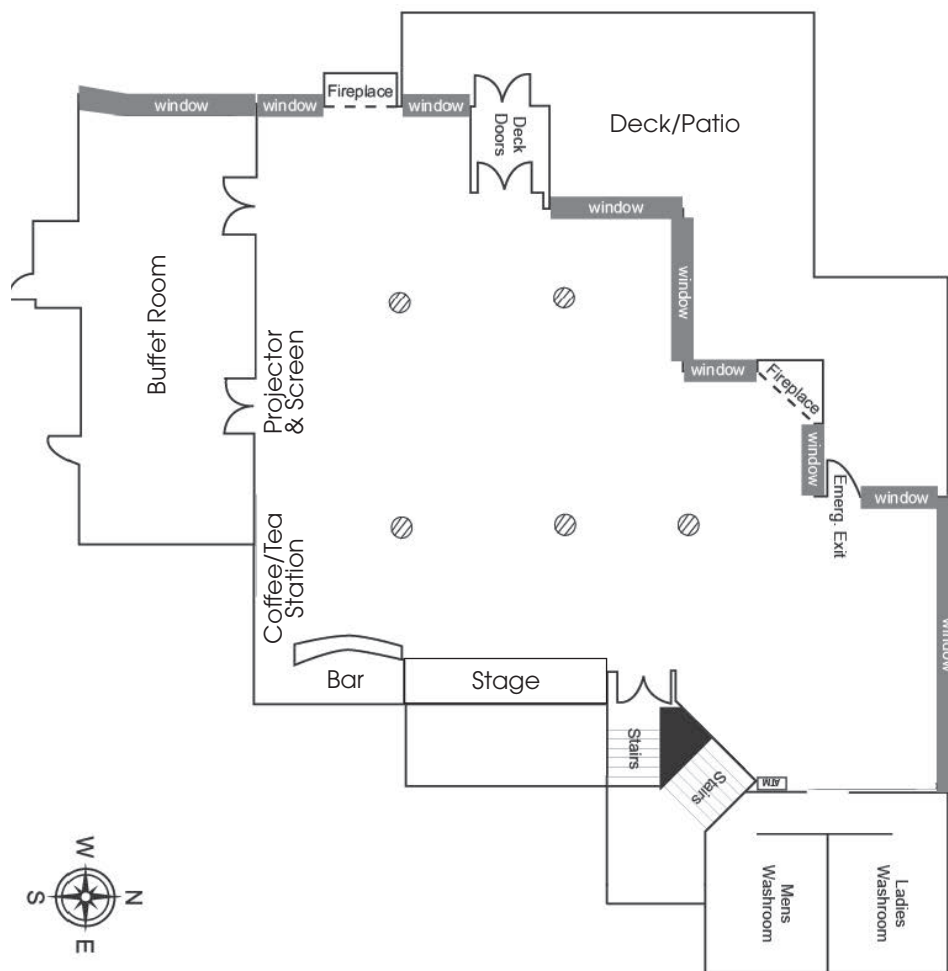

5% GST will be added to all prices.  
Food, beverage & corkage prices  
are subject to a 20% service  
charge.  
All prices are subject to change  
without notice.



# Policies & Agreements

Our Catering and Banquet professionals are committed to administer every detail to your complete satisfaction. In order to ensure that your function runs smoothly, we request you acknowledge the following policies:

- All catering prices are subject to change due to fluctuating costs. Prices are guaranteed three (3) months prior to the date of the function.
- A guaranteed number is required 72 hours prior to the function date. A signed copy of the catering contract will ensure that all agreed upon arrangements are fulfilled.
- All food is provided by Snow Valley. Removal of food from the premises is not permitted. Buffet items will be displayed for a maximum of 1-1/2 hours to ensure the quality and integrity of the products.
- Affixing any materials to the walls, floors, ceilings or furnishings is not permitted.
- Snow Valley is not responsible for the loss or damage of articles left in the facility prior, during or following any function.
- The client is responsible and shall reimburse Snow Valley for any and all damage caused to the premises, building, patio, deck and equipment.

The performance of this contract is contingent upon the ability of management to complete the same and is subject to the acts of God, labor troubles, disputes or strikes, accidents, government restrictions, transportation of food, beverages or supplies & other causes beyond the control of management preventing or interfering with performance.

Snow Valley has the authority to remove or have removed any person from the premises in the event that any provisions of the Catering Contract are breached, or in the event that you are not in compliance with any civic bylaw, provincial or federal act or regulation, or policies established from time to time by the Alberta Gaming and Liquor Commission or the Edmonton Police Department.

## PLEASE FILL OUT AND RETURN

The undersigned agrees to the above

Date of Function

Signature

Street Address

Print Name

City & Postal Code

Today's Date

e-Mail Address

5% GST will be added to all prices.  
Food, beverage & corkage prices are subject to a 20% service charge.  
All prices are subject to change without notice.



# *Get In Touch*

Let's work together to make  
your event a success!

The Lodge at Snow Valley  
13204 Rainbow Valley Road  
Edmonton, AB

For Inquiries  
Shelley Kozowy  
foodservices@snowvalley.ca  
780-809-2374  
thelodgeatsnowvalley.ca

**Elevate your  
corporate event  
to new heights!**

Ask us about adding  
a group booking at  
**discounted group  
rates** for our summer  
attractions.

[snowvalley.ca/aerial-park](http://snowvalley.ca/aerial-park)

